

Slim size Industrial Switch for Automation

DS108A

Industrial 8-port Unmanaged Ethernet Switch

DS108A is an industrial unmanaged Ethernet switch that provides 8-port Fast Ethernet for economical solution to industrial Ethernet connection. The rugged design can stand for harsh environment and wide temperature (from -40 to 75°C) use. The compact size can fit in for space limited cabinets. The power input can support 9.6~60VDC wide power input range.

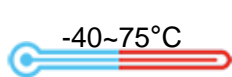

Features & Benefits

Broadcast Storm Protection

- Auto drop incoming broadcast packets for network availability protection
- Fast enable/disable through DIP Switch for customer requirement

QoS Service for Time-Sensitive Applications

- VIP port for Port 1/2
- Port base design for IEEE 802.1p, DiffServ, TCP/UDP port number
- Fast enable/disable through DIP Switch for customer requirement

IEEE 802.3az EEE Power Management

- Energy Efficient Ethernet
- Idle power saving mode for energy efficiency

Rugged Mechanical Design

- Robust design protects from mechanical deformation
- IP40 ingress protection to withstand harsh environment
- Wide operating temperature range **-40 ~ 75°C**
- Wide power input range 9.6~60VDC
- CE marking
- IEC61000-6-2/IEC61000-6-4 heavy industrial EMC



Interfaces

8-port 10/100Base-TX →



← Din Clip

← Power LED

Power Connector

- 1 x 4 pin terminal block
- 3 pin for power input
- Ground

DIP Switch

- BS
- QoS



Dimensions

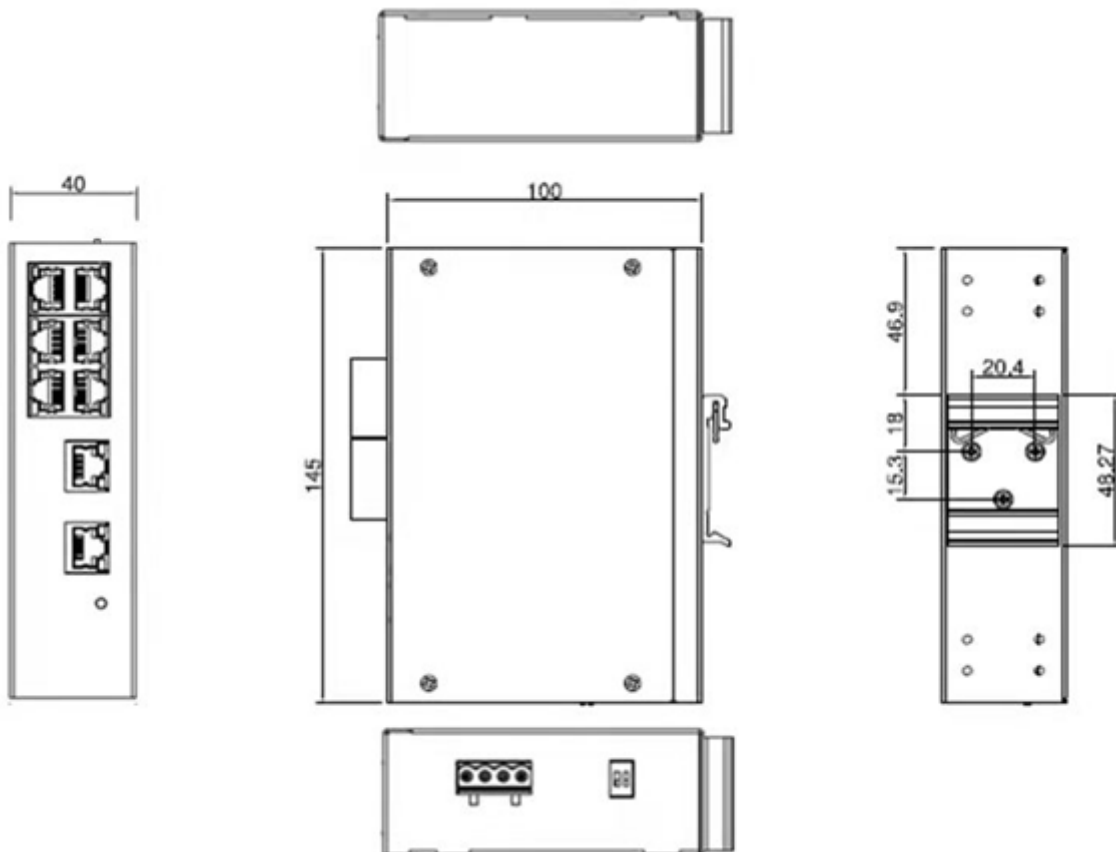

Technology	
Standard	IEEE 802.3 10Base-T Ethernet
	IEEE 802.3u 100Base-TX Fast Ethernet
	IEEE 802.3x Flow Control and back-pressure
	IEEE 802.1p Class of Service (CoS)
	IEEE 802.3az (Energy Efficient Ethernet)
Performance	
Switch Technology	Store and Forward Technology with Non-Blocking Switch Fabric
Number of MAC Address	1K
Packet Buffer Memory	448K bits
Transfer performance	10Base-T: 14,880pps, 100Base-TX: 148,800pps
Interface	
Ethernet Port	8 x 10/100Base-TX RJ45, Auto Negotiation
System LED	1 x Power: Green On
Ethernet Port LED	Link (Green On), Activity (Green Blinking)
DIP Switch	1 x Enable/disable broadcast storm protection 1 x Enable/disable QoS
Power input	4-Pin Removable Terminal Connector 3 Pin for Power Input (V+, V-, V+) 1 Pin for Ground
Power Requirement	
Input Voltage	12/24V/48DC (9.6~60VDC)
Reverse Polarity Protect	Yes
Input Current	0.05A@24V
Power Consumption	Max. 1.2W@24VDC; Full traffic, suggest to reserve 15% tolerance

Mechanical	
Installation	DIN Rail
Enclosure Material	Steel Metal
Dimension	100mm (D) x 145mm (H) x 40mm (W) / without DIN Rail Clip
Ingress Protection	IP40
Weight	500g without package

Environmental	
Operating Temperature & Humidity	-40°C~75°C , 0%~95% Non-Condensing
Storage Temperature	-40°C~80°C
MTBF	>200,000 hours
Hi-Pot Insulation	AC1.5KV for Power/Ethernet port to Chassis Ground
Warranty	5 years

Standard	
EMC	EN61000-6-2/EN61000-6-4
EMI	CISPR 22, FCC part 15B Class A
EMS	EN61000-4-2 ESD: 8KV(Air), 6KV(Contact) EN61000-4-3 RS: 20V/m(80M~1GHz), 10V/m(1.4G~2.1GHz), 5V/m(2.1G~2.5GHz) EN61000-4-4 EFT: 2KV (Power, Signal Port, GND) EN61000-4-5 Surge: Power: 2KV/1KV(Line to Ground/Line to Line), Signal Port: 2KV(Line to Ground) EN61000-4-6 CS: 10Vrms(Power, Signal Port) EN61000-4-8 Magnetic Field: 30A/m continues /300A for 1~3s



Ordering Information

Model Name	Description
DS108A	Industrial 8-port Unmanaged Ethernet Switch
	Package List
	1 x Product Unit
	1 x 4-pin Removable Terminal Connector
	1 x Attached Din Clip
	1 x Quick Installation Guide